

For immediate assistance or information
call ext. 5555 from any internal phone.

For visiting hours, please call or visit our website
541-447-6254 | StCharlesHealthCare.org

Campus Map



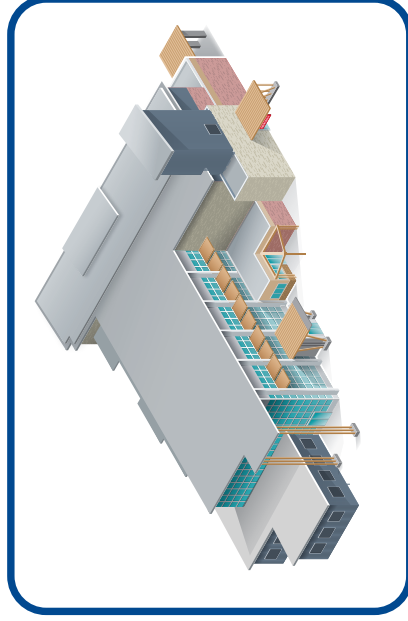

541-447-6254 | 384 SE Combs Flat Road
Prineville, OR 97754

stcharleshealthcare.org [f](#) [x](#) [@](#) [v](#)





SYMBOL LEGEND

-  Reception
-  Restroom
-  Elevator
-  Stairs

DEPARTMENT

Administration	Second
Combs Flat Kitchen	First
Conference Rooms	Second
Emergency Department	First
Family Care/Specialists	First
Financial Services	First
Healing Garden	First
Laboratory	First
Medical/Surgical	Second
Meditation Room	Second
Operating Rooms	First
Outpatient Rehabilitation	First
Surgery	First
Urgent Care	First